

FECHADURA CORRER 815A

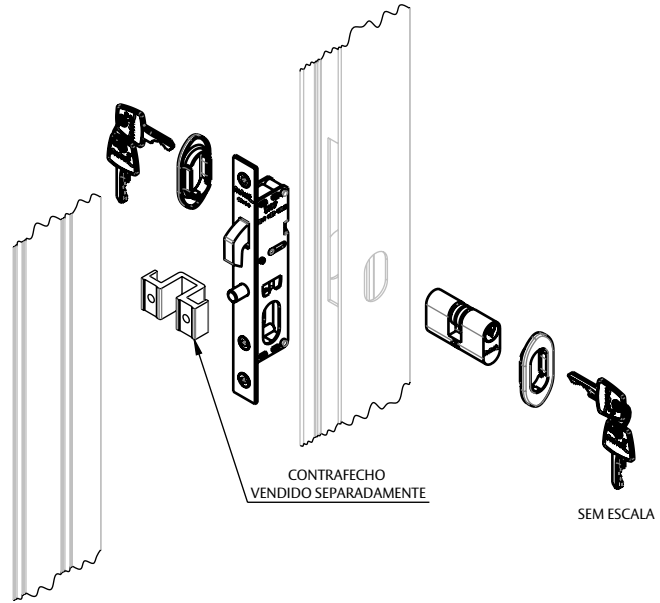

APLICAÇÃO



CARACTERÍSTICAS

CODIFICAÇÃO			
VERSÃO	COR	CÓDIGO	CATÁLOGO
400/45	BCO	9700507	FRA815A40045RDBR
	PTF	9700509	FRA815A40045RDPF
	PRA	9700508	FRA815A40045RDPR
400/45 C/CTT	PTF	9700306	FRA815A40045RDCTTFL
	CR	9700307	FRA815A40045RDCTTCL
400/60	BCO	9700177	FRA815A40060RDBR
	PTF	9700179	FRA815A40060RDPF
	PRA	9700368	FRA815A40060RDPR
400/90	BCO	9700303	FRA815A40090RDBR
	PTF	9700302	FRA815A40090RDPF
401/30	BCO	9700180	FRA815A40130RDBR
	PTF	9700182	FRA815A40130RDPF
	PRA	9700371	FRA815A40130RDPR

USINAGEM FECHADURA

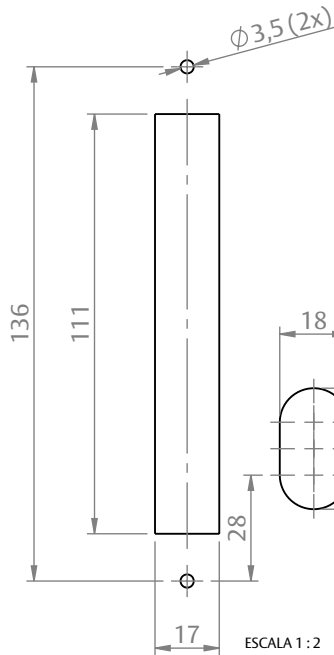

DIMENSÕES FECHO 815A

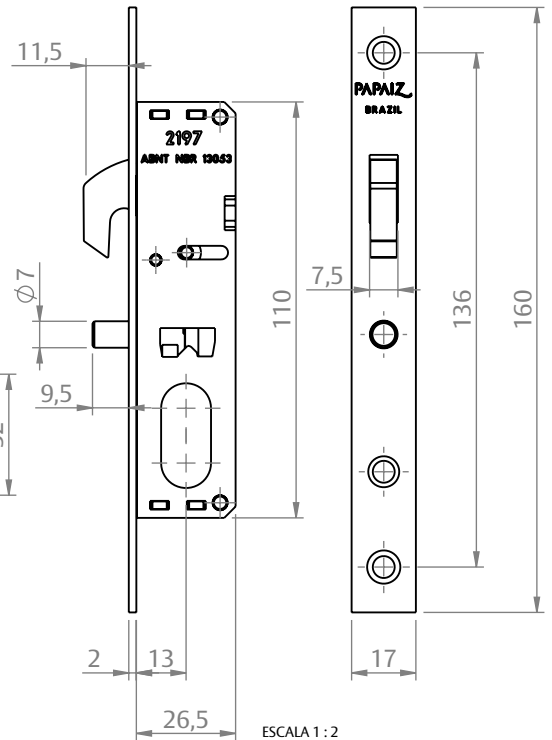

OBSERVAÇÕES

- CONTRAFECHO VENDIDO SEPARADAMENTE.

COMPOSIÇÃO/CARACTERÍSTICAS:

- FECHADURA: ALUMÍNIO / AÇO CARBONO ZINCADO;
- CILINDRO: ALUMÍNIO/LATÃO;
- CHAVES: LATÃO;
- PARAFUSOS: AÇO INOX.

DIMENSÕES ROSETA

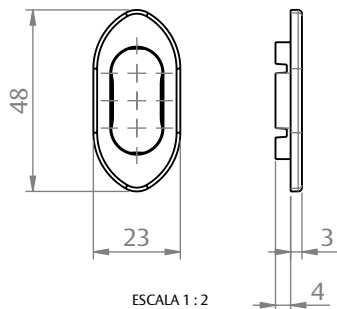

DIMENSÕES CILINDRO

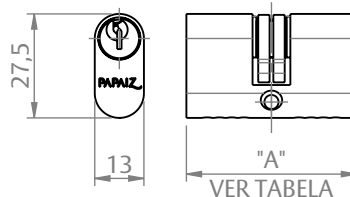

MODELO	COTA "A" (mm)
400/45	45
400/60	60
400/90	90
401/30	38,5

PORTA DE CORRER

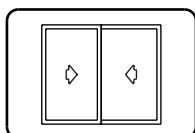

UDINESE
ASSA ABLOY

FECHADURA CORRER 815A

APLICAÇÕES

D'ORO
(CDA ALUMIGON)

FECHAMENTO LATERAL

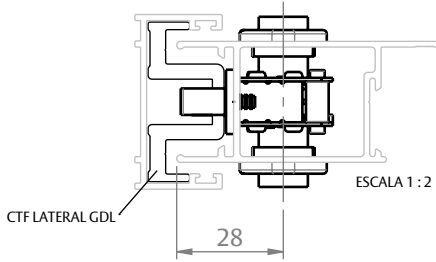

FECHAMENTO CENTRAL

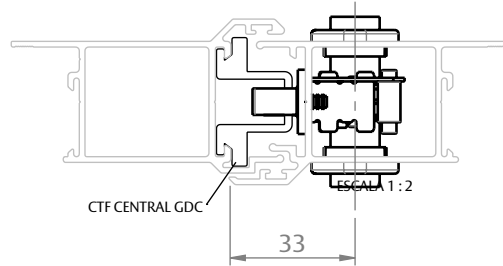

ALUK 3.2
(OLGA COLOR)

FECHAMENTO LATERAL

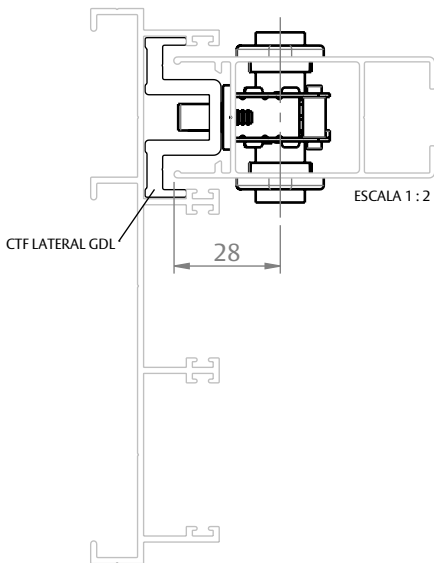

FECHAMENTO CENTRAL

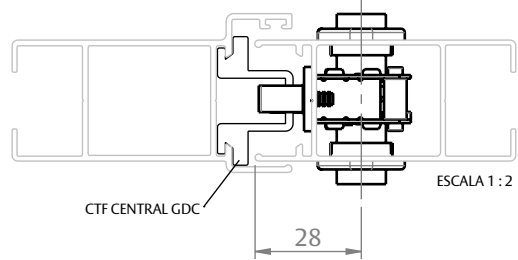

MEGA 32
(ASA ALUMÍNIO)

FECHAMENTO LATERAL

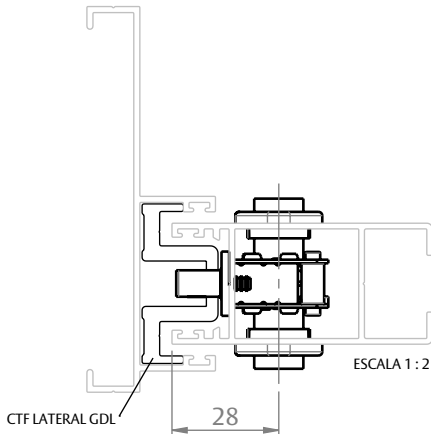

FECHAMENTO CENTRAL

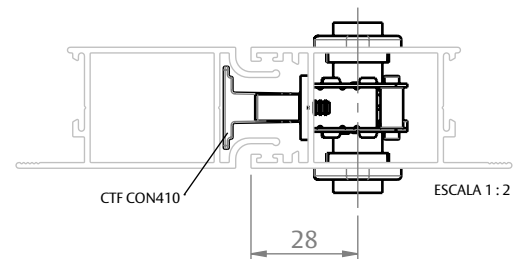

UDINESE
ASSA ABLOY

FECHADURA CORRER 815A

APLICAÇÕES

**GOLD
(HYDRO)**

FECHAMENTO LATERAL

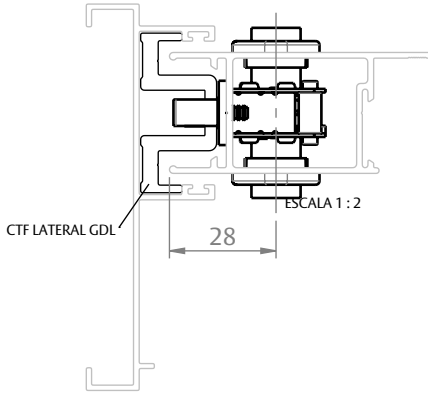

FECHAMENTO CENTRAL

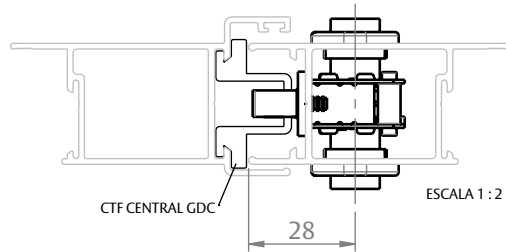

**OFFICIAL
(HYDRO)**

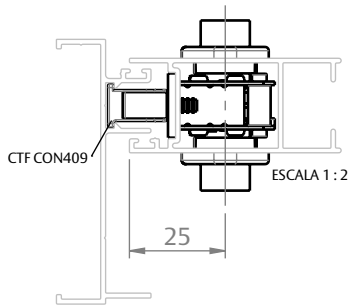

**SUPREMA
(HYDRO)**

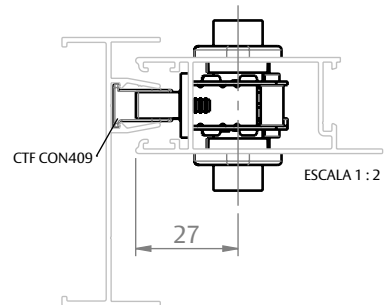

**IMPERIAL 3.5
(BELMETAL)**

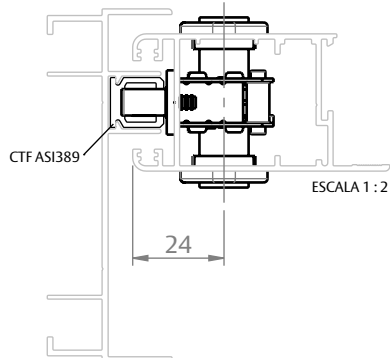

SLIM

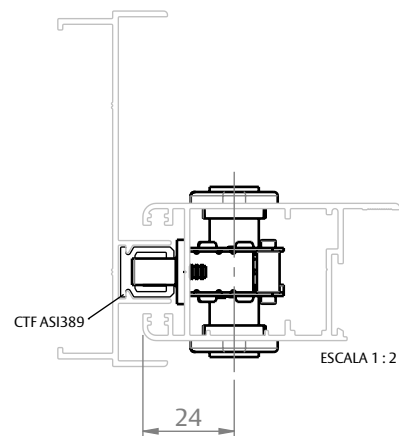

UDINESE
ASSA ABLOY

FECHADURA CORRER 815A

APLICAÇÕES

**IMPERIAL 2.5
(BELMETAL)**

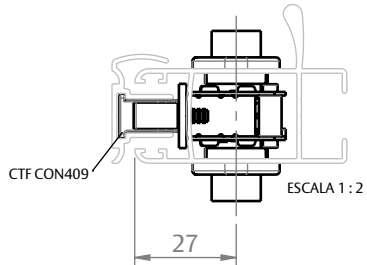

**CHROMA
(PERFIL ALUMÍNIO)**

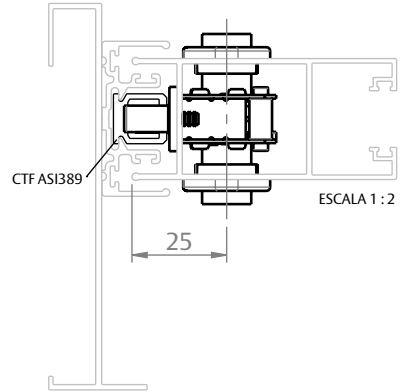

**ECOLINE 2.5
(PERFIL ALUMÍNIO)**

